

March 10, 2025

Dear Wallowa Fiddle Tunes Campers,

We are entering our 20th year of fiddle camp! This welcome letter gives you some basics as you think ahead to camp. Check in is Sunday, July 6th, starting at 3 pm.

Afternoon electives are offered Monday, Tuesday, and Thursday. They are subject to change, depending on what faculty and campers decide to share with each other. These electives are a great opportunity to practice a second instrument, so consider bringing more than one instrument to camp.

The Wallowa School District has requested that we have no alcohol, drugs, campfires or firearms on school property. Dogs are welcome on the grounds, and must remain on a leash and be cleaned up after. The school dumpster on the north side of the building is available for camper garbage, but plan to carry home your recyclables. No cars are allowed to drive into the playground area for unloading at this time, I will confirm this as we get closer to camp starting. There is plenty of street parking or spots in the lots on the north side of the building. Unloading can be done by pulling up on W First Street (front of school).

Quiet hours are 11 pm until 7 am.

You are welcome to tent camp on the grassy south side of the school, which is also near the school playground. Another option is to park an RV/van in the parking lots on the north side of the school. All options are dry camping. If you want hook ups, check out Wallowa River RV Park, <https://wallowariverrvpark.com/>

Items you might consider bringing: armless chairs, folding table, camp stove, cooler (ice is available to buy at the corner market) headlamp, bug repellent, sunscreen and hat, rain jacket, awning or canopy for shade and weather protection, extra blanket and sleeping bag, garbage bags (for storing items if it rains), drinking water storage container, ear plugs, recording device, extra instrument strings, small bills (for ice, coffee, snacks, CD's), and lawn games.

School showers are available in the new gym. Please respect the school and only enter the new gym building for shower and bathroom use. The gym showers/bathrooms will be open 7 am - 9 pm. The bathrooms across from the cafeteria/Beth Johnson Room are open 24 hours a day. The classrooms are now equipped with air conditioning and the cafeteria/Beth Johnson Room will have a swamp cooler going. I have confirmed with the school that the air conditioning units will be serviced before we have camp this year and will work in classrooms!

The new Wallowa Bike Park is on the north side of the school and provides another play space to families. It is sandwiched between the parking lots that we will use for parking and RV camping. Kids who are not in class need to be supervised by an adult.

Remember you can pre-purchase lunch through the camp registration website. Lunch is Monday - Friday (Z's BBQ will cater, \$85), and you bring breakfast and dinner. <https://wvmusicalliance.org/wftc-2025/>

You can also pre-purchase a camp t-shirt through the camp registration website. I have a few t-shirts from past years, but if you want the 20 year 2025 shirt please pre order it.

Your camp instructor will contact you by mid June and I look forward to seeing you on July 6th.

~Robyn Burns (503)423-7730 cell

			Wallowa Fiddle Tunes Camp 2025										
	Sun	Mon	Tue		Wed		Thu		Fri				
8:15 AM		Coffee	Coffee		Coffee		Coffee		Coffee				
8:45 AM		Camper Meeting	Camper Meeting		Camper Meeting		Camper Meeting		Camper Meeting				
9:00 AM		Morning Session	Morning Session		Morning Session		Morning Session		Performance Practice				
	Classroom Clean-up												
10:00 AM													
10:15 AM													
10:45 AM		Morning Break	Morning Break		Morning Break		Morning Break						
		Morning Session Continued	Morning Session Continued		Morning Session Continued		Morning Session Continued		Farewell Music and Dance Concert: 10:30				
Noon		Lunch	Lunch		Lunch		Lunch		Lunch / Goodbyes				
1:00 PM		Afternoon Session	Afternoon Session		Afternoon Session		Afternoon Session						
2:15 PM		15 Min. Break				Free Afternoon		15 Min. Break					
2:30 PM		Electives		Electives				Electives		Dance Band Elective			
3:00 PM	Check-in, Set Up Campsite												
		15 Min. Break						15 Min. Break					
3:45 PM													
4:00 PM	Check-in, Set Up Campsite	Student-led Elective	Dance Band Elective	Student-led Elective	Dance Band Elective			Student-led Elective					
5:00 PM		Free Time		Free Time						Faculty Perform at Courthouse Concert in Enterprise			
5:30 PM													
6:30 PM	Camper Orientation							Gather at M. Crow in Lostine for food, drink and jamming.					
7:00 PM	Instructor Concert	Open Mic		Square Dance									
8:00 PM	Community Dance												
9:00 PM	Campsite Jams	Campsite Jams		Campsite Jams		Campsite Jams				Campsite Jams			
11:00 PM	Music Curfew	Music Curfew		Music Curfew		Music Curfew		Music Curfew - Extended					

Instructor name	Monday 7-Jul-25 2:30-3:30 pm	Tuesday 8-Jul-25 2:30-3:30 pm	Thursday 9-Jul-25 2:30-3:30 pm
Carla Arnold	Be the life of any small musical gathering: Learn to dance and teach a simple, and fun community dance.	Introduction to locating finger patterns on the fiddle for playing the root of basic 3 chords (1, 4 and 5) in multiple keys.	
Robyn Burns	Argentine tango	Argentine tango	Dance Band Elective
Richard Melling	Singing - Tone, technique, harmony and repertoire	Singing - Tone, technique, harmony and repertoire	Singing - Tone, technique, harmony and repertoire
Matt Bell	Multiple Musical Guitars: Understand the roles and ranges of various other instruments to make 3 or 4 (or more!) guitars sound like a band.	Guitar Tricks: Bass Run's, Kickoff's & Fills (for guitar and other instruments)	Learn the World's Greatest Song in Only 1 Hour
Duane Boyer	Yodeling, 3-part harmony singing, or different levels of three-finger style Bluegrass banjo	Yodeling, 3-part harmony singing, or different levels of three-finger style Bluegrass banjo	Yodeling, 3-part harmony singing, or different levels of three-finger style Bluegrass
Jacie Sites	Technique master class/fiddle tips	Technique master class/fiddle tips	Technique master class/fiddle tips
Kate Lichenstein	Fiddling with octaves - playing tunes in low and high registers to add energy and interest to your jam.	Let's write a fiddle tune - we'll each contribute and make new old-time music.	Dance Band Elective



Map of inside of Wallowa School



Done

Elementary Emergency Escape Route

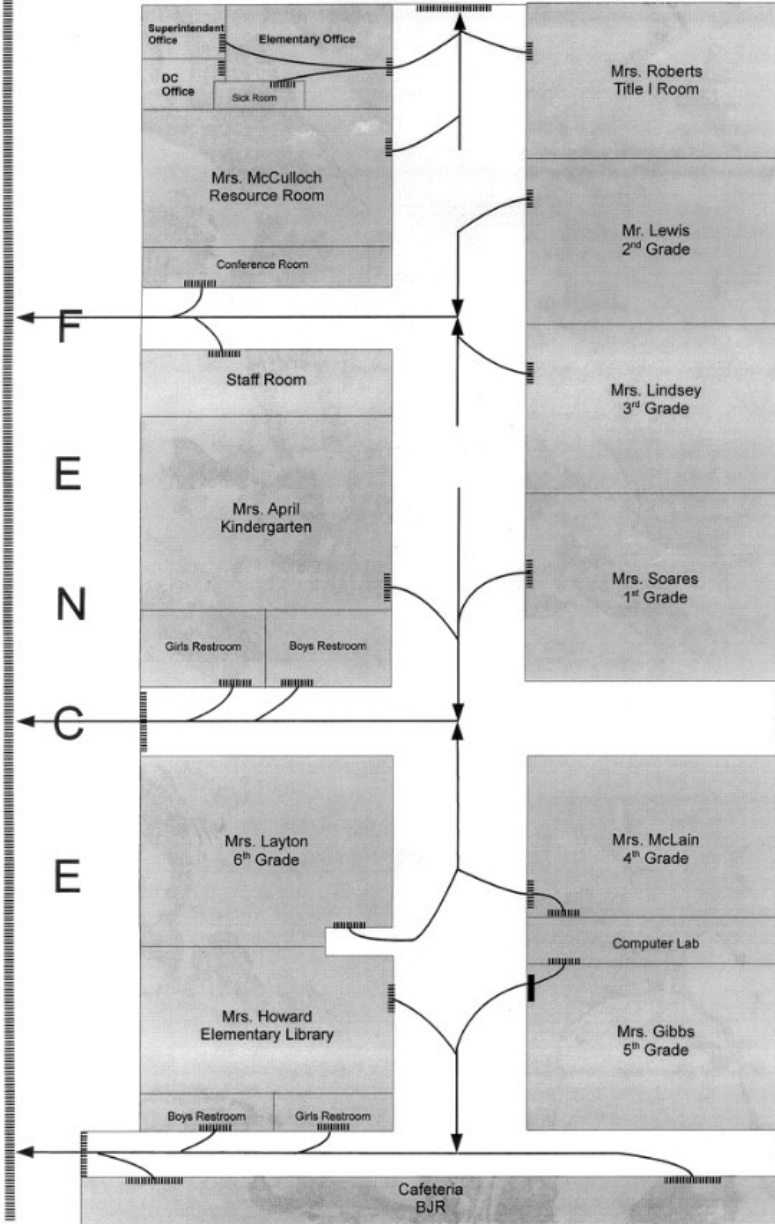
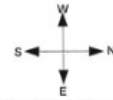

1 of 1

